

Decorative Hardware

Hinges

Turntables

Cabinet Organizers

Drawer Slides

TURNTABLES

shepherd[®]

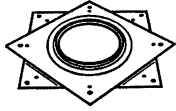

4" Dia.

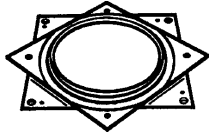

6" Dia.

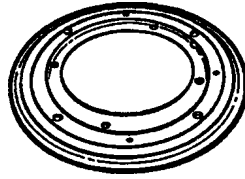

12" Dia.

- Use to make turntables for rotating book racks, business machine stands, serving trays, kitchen storage racks, etc.
- With ball bearings.

ORDER #	SIZE	LOAD RATING	PKG.	UNIT
9547	4"	200 lbs.	10	EACH
9548	6"	500 lbs.	10	EACH
9549	12"	1000 lbs.	10	EACH

U.S. Futaba, Inc.

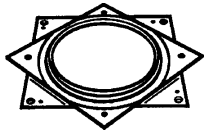

6" Dia.

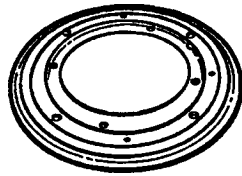

12" Dia.

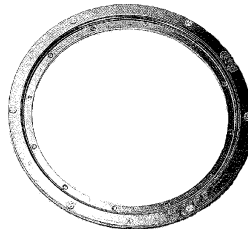

13" Dia.

- Use to make turntables for rotating book racks, business machine stands, serving trays, kitchen storage racks, etc.
- With ball bearings.

ORDER #	SIZE	LOAD RATING	PKG.	UNIT
TR 6C	6"	500 lbs.	100	EACH
TR 12C	12"	1000 lbs.	25	EACH
FT54300	13"	220 lbs.	20	EACH

LAZY SUSAN HARDWARE - INDIVIDUAL COMPONENTS

REV-A-SHELF[®]

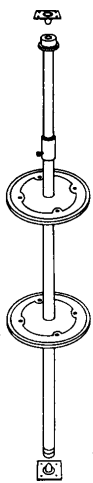

6020-04-52



6020-96-36-2



6000-07-52

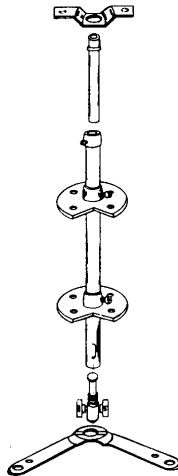

6120-04-52

Full Circle Hardware Set:

- For use with wood or laminate shelves.
- Contains: top & bottom pivots, center shaft assembly, upper shaft assembly, collar assembly, two full circle shelf supports & mounting screws.

Center shaft:

- For use with full circle independently rotating sets in 36" and 42" wall cabinet applications.

Pie Cut Hardware Set:

- For 18"-22" pie cut wood or laminate shelves.

ORDER #	DESCRIPTION	PKG.	UNIT
6000-07-52	FULL CIRCLE SHELF SUPPORT	12	SET
6020-04-52	FULL CIRCLE HARDWARE SET	1	SET
6020-96-36-2	36" x 3/4" DIA. CENTER SHAFT	1	SET

PIVOT HARDWARE

Washington

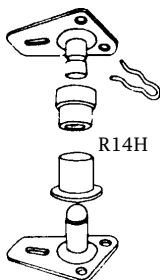

R14H

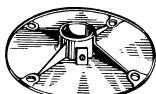

R14B



SB2

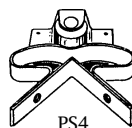

PS4

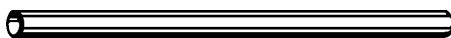

P19

ORDER #	DESCRIPTION	PKG.	UNIT
R14H	PIVOT HARDWARE	12	EACH
R14B	FULL CIRCLE SHELF SUPPORT	12	EACH
SB2	PIE CUT SHELF SUPPORT	12	EACH
P19	PIVOT POST - 27-1/2" L x 1" O.D.	12	EACH
PS4	POSITION STOP	12	EACH

FULL CIRCLE LAZY SUSANS - POLYMER TRAY



6012 SERIES



6072 SERIES



6013 SERIES

- Shelf heights can be adjusted easily with one screw.
- INDIVIDUAL SETS**
- **6012 Series Dependently Rotating:** 3/4" dia. telescoping center shaft (12" upper & 31" lower) to accommodate 24"-31" I.C.H.; 2 shelves; top & bottom pivots-complete with screws.
- **6012 Series Dependently Rotating:** 3/4" dia. telescoping center shaft (12" upper & 36" lower) to accommodate 38"-46" I.C.H.; 3 shelves; top & bottom pivots-complete with screws.
- **6072-Series Independently Rotating:** 1 collar assembly, 1" dia. telescoping center shaft (9-1/4" upper & 22-1/2" lower) assembly to accommodate 26"-32" I.C.H.; 2 shelves & mounting hardware.

BULK SETS

- Shelves and hardware sold separately.
- Sold in full cases only: 12 shelves/case; 6 sets of hardware/case.

ORDER #	SIZE	DESCRIPTION	COLOR	PKG.	UNIT
6012-18-11-52	18"	2-SHELF SET	WHITE	1	SET
6012-18-15-52	18"	2-SHELF SET	ALMOND	1	SET
6012-20-11-52	20"	2-SHELF SET	WHITE	1	SET
6012-20-15-52	20"	2-SHELF SET	ALMOND	1	SET
6012-24-11-52	24"	2-SHELF SET	WHITE	1	SET
6012-24-15-52	24"	2-SHELF SET	ALMOND	1	SET
6012-28-11-52	28"	2-SHELF SET	WHITE	1	SET
6012-28-15-52	28"	2-SHELF SET	ALMOND	1	SET
6072-32-11-52	32"	2-SHELF SET	WHITE	1	SET
6072-32-15-52	32"	2-SHELF SET	ALMOND	1	SET
6013-18-11-526	18"	3-SHELF SET	WHITE	1	SET
6013-20-11-526	20"	3-SHELF SET	WHITE	1	SET
6001-18-11-4	18"	BULK-TRAY ONLY	WHITE	12	EACH
6001-18-15-4	18"	BULK-TRAY ONLY	ALMOND	12	EACH
6001-20-11-4	20"	BULK-TRAY ONLY	WHITE	12	EACH
6001-20-15-4	20"	BULK-TRAY ONLY	ALMOND	12	EACH
6001-24-11-4	24"	BULK-TRAY ONLY	WHITE	12	EACH
6001-28-11-4	28"	BULK-TRAY ONLY	WHITE	12	EACH
6001-28-15-4	28"	BULK-TRAY ONLY	ALMOND	12	EACH
6022-04-4	24"-31"	BULK - HDWE ONLY	CHROME	6	SETS
6022-04-52-526	38-46"	HARDWARE ONLY	CHROME	4	SETS

SINGLE REPLACEMENT SHELVES - POLYMER TRAY

- For use as replacements or where extra shelves are needed.

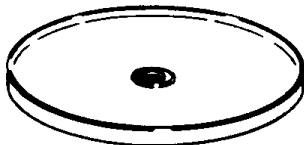

ORDER #	SHELF DIA.	COLOR	PKG.	UNIT
6001-18-11-52	18"	WHITE	1	SET
6001-20-11-52	20"	WHITE	1	SET
6001-20-15-52	20"	ALMOND	1	SET
6001-24-11-52	24"	WHITE	1	SET
6001-28-11-52	28"	WHITE	1	SET
6001-28-15-52	28"	ALMOND	1	SET

FULL CIRCLE LAZY SUSANS - WOOD TRAY



- Wood Classics full circle lazy susans offer the beauty of maple without the worries of warping and splitting. Durable wood shelf is made with a 5/8" thick high-density multi-ply tray & 1" high solid wood rim protected with a UV-cured clear coat finish.
- 1" inside tray height; 1-5/8" outside rim height.



INDIVIDUAL SETS

- **4WLS072-Series Independently Rotating:** 1" dia. telescoping center shaft (9-1/4" upper & 22-1/2" lower) assembly to accommodate 26"-32" I.C.H.; 2 shelves & mounting hardware.
- **4WLS073-Series Independently Rotating:** 1" dia. telescoping center shaft (12" upper & 36" lower) assembly to accommodate 38"-46" I.C.H.; 3 shelves & mounting hardware.

ORDER #	SIZE	DESCRIPTION	COLOR	PKG.	UNIT
4WLS072-20-52	20"	2-SHELF SET	WOOD	1	SET
4WLS072-28-52	28"	2-SHELF SET	WOOD	1	SET
4WLS072-32-52	32"	2-SHELF SET	WOOD	1	SET
4WLS073-20-53	20"	3-SHELF SET	WOOD	1	SET

FULL CIRCLE SHELF W/SWIVEL & BEARING - WOOD TRAY



top view

bottom view



INDIVIDUAL SETS

- Comes with swivel & bearing attached to tray.

ORDER #	SIZE	DESCRIPTION	COLOR	PKG.	UNIT
4WLS001-20-B5	20"	TRAY W/SWIVEL	WOOD	1	SET
4WLS001-28-B5	28"	TRAY W/SWIVEL	WOOD	1	SET
4WLS001-32-B5	32"	TRAY W/SWIVEL	WOOD	1	SET

CHROME FENCE RAIL - FOR WOOD OR POLYMER TRAYS



- Enhance your wood or polymer lazy susans with chrome fence railing.
- Designed to fit Rev-A-Shelf 4WLS wood, polymer or custom trays.

ORDER #	SIZE	DESCRIPTION	COLOR	PKG.	UNIT
5LSF020-CR	20"	FULL CIRCLE RAIL	CHROME	1	SET
5LSF428-CR	28"	KIDNEY RAIL	CHROME	1	SET
5LSF432-CR	32"	KIDNEY RAIL	CHROME	1	SET

FULL CIRCLE SHELVES W/SWIVEL & BEARING - (2 SHELF KIT) - WOOD TRAY



- 1-3/4" lip height.
- 12mm plywood shelf fenced with rugged 10-ply maple rim
- 450lb capacity, long life, smooth travel cast aluminum bearing, attached.
- Access hole (with supplied decorative cover cap) for easy installation
- Set includes: 2 trays with attached cast bearings.

ORDER #	SIZE	DESCRIPTION	SPECIES	PKG.	UNIT
T7228K30TRDCBMNL1	28"	2-SHELF SET	MAPLE	1	SET
T7232K30TRDCBMNL1	32"	2-SHELF SET	MAPLE	1	SET

REVOLVING D-SHAPE SHELF SETS - POLYMER TRAY



7012 SERIES

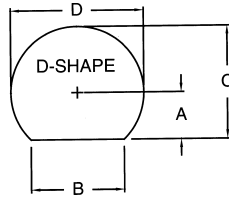

DIMENSIONS

- 7012-20: A=8-7/8"; B=9-1/4"; C=9-1/4"; D=20"

INDIVIDUAL SETS

- 7012 Set Contents: 3/4" Dia. telescoping center shaft (12" upper & 36" lower) to accommodate 24-31" I.C.H.; 2 shelves; top & bottom pivots-complete with screws.
- Dependently rotating trays.

ORDER #	SIZE	DESCRIPTION	COLOR	PKG.	UNIT
7012-20-11-52	20"	2-SHELF SET	WHITE	1	SET

D-SHAPE SHELF W/SWIVEL & BEARING - WOOD TRAY



top view

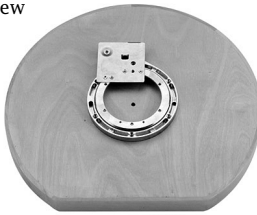

bottom view

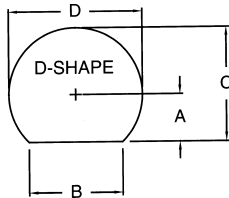

- 1" inside tray height; 1-5/8" outside rim height.

DIMENSIONS

- 4WLS201-20: A=8-3/8"; B=11"; C=18-3/8"; D=20".
- 4WLS201-31: A=14"; B=12-7/8"; C=29-1/2"; D=31".

INDIVIDUAL SETS

- 4WLS201-Series: Swivel and bearing stop attached to tray.

ORDER #	SIZE	DESCRIPTION	COLOR	PKG.	UNIT
4WLS201-20-BS52	20"	2-SHELF SET	WOOD	1	SET
4WLS201-31-BS52	31"	2-SHELF SET	WOOD	1	SET

REVOLVING KIDNEY SHELF SETS - POLYMER TRAY



6472 SERIES

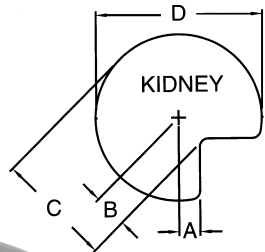

- 1" Shaft system.
- Independently rotating hardware

DIMENSIONS

- 6472-18: A=1-3/4"; B=2-13/16"; C=11-13/16"; D=18".
- 6472-24: A=1-1/2"; B=2-5/16"; C=14-5/16"; D=24".
- 6472-28: A=3"; B=4-11/16"; C=18-5/8"; D=28".
- 6472-32: A=4-1/4"; B=6-7/16"; C=22-7/16"; D=32".

INDIVIDUAL SETS

- 6472-Series Set Contents: Two shelves, 31" telescoping center shaft (12" upper & 21" lower) to accommodate 26"-32" I.C.H., top and bottom pivots - complete with screws.

BULK SETS

- Same contents as above, sold in full cases of 5 sets only.

ORDER #	SIZE	DESCRIPTION	COLOR	PKG.	UNIT
6472-18-11-52	18"	2-SHELF SET	WHITE	1	SET
6472-24-11-52	24"	2-SHELF SET	WHITE	1	SET
6472-28-11-52	28"	2-SHELF SET	WHITE	1	SET
6472-28-15-52	28"	2-SHELF SET	ALMOND	1	SET
6472-32-11-52	32"	2-SHELF SET	WHITE	1	SET
6472-32-15-52	32"	2-SHELF SET	ALMOND	1	SET
6472-28-11-4S	28"	BULK 2-SHELF SET	WHITE	5	SET
6472-28-15-4S	28"	BULK 2-SHELF SET	ALMOND	5	SET

REVOLVING KIDNEY SHELF SETS - PREMIERE CHROME

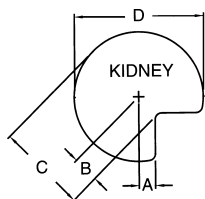
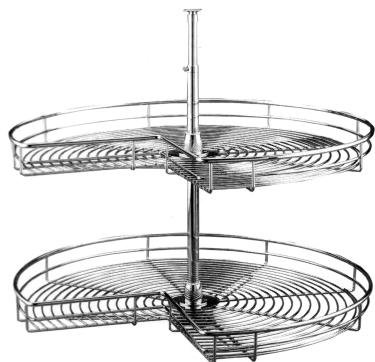

- 1" shaft system
- Independently rotating trays.

DIMENSIONS

- 5472-28: A=3"; B=4-3/8"; C=18-7/16"; D=28-1/8".
- 5472-32: A=4-1/8"; B=6"; C=22-1/16"; D=32-1/8".

INDIVIDUAL SETS

- 5472-Series sets contain: Two shelves, 1" diam. telescoping center shaft (9-1/4" upper & 22-1/2" lower) to accommodate 26"-32" I.C.H.; and mounting hardware.

ORDER #	SIZE	DESCRIPTION	COLOR	PKG.	UNIT
5472-28-CR	28"	2-SHELF SET	CHROME	1	SET
5472-32-CR	32"	2-SHELF SET	CHROME	1	SET

KIDNEY LAZY SUSANS - WOOD TRAY

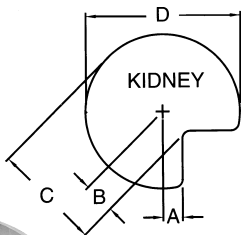

- Wood Classics kidney lazy susans offer the beauty of maple without the worries of warping and splitting. Durable wood shelf made with a 5/8" thick high-density multi-ply tray & 1" high solid wood rim protected with a UV-cured clear coat finish.
- 1" inside tray height; 1-5/8" outside rim height.

DIMENSIONS

- 4WLS472-24: A=1-7/16"; B=2-1/4"; C=14-1/4"; D=23-15/16".
- 4WLS472-28: A=2-7/8"; B=4-1/16"; C=18-1/4"; D=27-3/4".
- 4WLS472-32: A=4-1/16"; B=5-3/4"; C=21-15/16"; D=31-3/4".

INDIVIDUAL SETS

- 4WLS472-Series **Independently Rotating**: 1" dia. telescoping center shaft (9-1/4" upper & 22-1/2" lower) assembly to accommodate 26"-31" I.C.H; 2 shelves & mounting hardware.

ORDER #	SIZE	DESCRIPTION	COLOR	PKG.	UNIT
4WLS472-24-52	24"	2-SHELF SET	WOOD	1	SET
4WLS472-28-52	28"	2-SHELF SET	WOOD	1	SET
4WLS472-32-52	32"	2-SHELF SET	WOOD	1	SET

KIDNEY SHELF W/SWIVEL & BEARING - WOOD TRAY



top view



bottom view

- Same tray dimensions as kidney sets above.

INDIVIDUAL SETS

- Comes with swivel & bearing stop attached to tray.

ORDER #	SIZE	DESCRIPTION	COLOR	PKG.	UNIT
4WLS401-28-BS52	28"	TRAY W/SWIVEL	WOOD	1	SET
4WLS401-32-BS52	32"	TRAY W/SWIVEL	WOOD	1	SET

KIDNEY SHELVES W/SWIVEL & BEARING - (2 SHELF KIT) - WOOD TRAY



- 1-3/4" lip height.
- 12mm plywood shelf fenced with rugged 10-ply maple rim
- 450lb capacity, smooth travel cast aluminum bearing, attached.
- Access hole (with supplied decorative cover cap) for easy installation
- Set includes: 2 trays with attached cast bearings.

ORDER #	SIZE	DESCRIPTION	SPECIES	PKG.	UNIT
T8228K30TRDCBMNL1	28"	2-SHELF SET	MAPLE	1	SET
T8332K30TRDCBMNL1	32"	2-SHELF SET	MAPLE	1	SET

SELECT SERIES DEEP BIN LAZY SUSAN - WOOD TRAY



- All-wood maple and birch construction, prefinished, 6" Deep Tray
- Designed for pots, pans, kitchen appliances and bulk food storage
- 450-pound capacity Cast aluminum bearing, with detent
- 30" Pie cut fits 33" and 36" corner cabinets

ORDER #	SIZE	DESCRIPTION	SPECIE	PKG.	UNIT
T8530K30TR6DCBMNL1	30"	SINGLE SHELF	MAPLE	1	SET

REVOLVING PIE CUT SHELF SETS - POLYMER TRAY



DIMENSIONS

- 6142-18: A=7/8"; B=1-1/4"; C=10-1/4"; D=18".
- 6142-22: A=1-1/8"; B=1-9/16"; C=12-9/16"; D=22".
- 6942-24: A=1-3/8"; B=1-15/16"; C=13-15/16"; D=24".
- 6942-28: A=3"; B=4-1/4"; C=18-1/4"; D=24".

INDIVIDUAL SETS

- **6142 Series** - two (2) shelves, telescoping shaft (12" upper & 21" lower) assembly to accommodate 24"-31" I.C.H. top and bottom pivots.
- Note: Standard centering hardware. Raises 3/8" as unit rotates in and out of detent.
- **6942 Series** - two (2) shelves, top pivot, cam base, telescoping center shaft assembly to accommodate 24"-31" I.C.H. 6940 not available in less than 24" diameter shelves.
- Note: 24" set has small cam base and 28" set has large cam base standard.

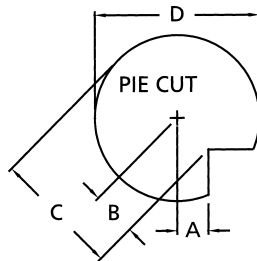

6942 SERIES

ORDER #	SIZE	DESCRIPTION	COLOR	PKG.	UNIT
6142-18-11-52	18"	2-SHELF SET	WHITE	1	SET
6142-22-11-52	22"	2-SHELF SET	WHITE	1	SET
6942-24-11-52	24"	2-SHELF SET	WHITE	1	SET
6942-24-15-52	24"	2-SHELF SET	ALMOND	1	SET
6942-28-11-52	28"	2-SHELF SET	WHITE	1	SET
6942-28-15-52	28"	2-SHELF SET	ALMOND	1	SET
6101-22-11-52	22"	REPL. TRAY ONLY	WHITE	1	EACH
6901-24-11-4	24"	BULK TRAY ONLY	WHITE	12	EACH
6901-28-11-4	28"	BULK TRAY ONLY	WHITE	12	EACH
6942-04-28-4	28" BULK - HDWE ONLY	CHROME	6	SETS	

PIE CUT LAZY SUSANS - WOOD TRAY

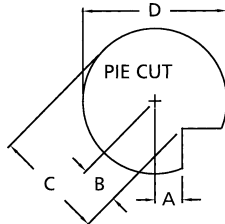

- Wood Classics pie cut lazy susans offer the beauty of maple without the worries of warping and splitting. Durable wood shelf made with a 5/8" thick high-density multi-ply tray & 1" high solid wood rim protected with a UV-cured clear coat finish.
- 1" inside tray height; 1-5/8" outside rim height.

DIMENSIONS

- 4WLS942-24: A=1-3/8"; B=1-15/16"; C=13-15/16"; D=24".
- 4WLS942-28: A=3"; B=4-1/4"; C=18-1/4"; D=28".

INDIVIDUAL SETS

- **4WLS942-Series Independently Rotating:** 1" dia. telescoping center shaft assembly to accommodate 26"-32" I.C.H.; 2 shelves.

ORDER #	SIZE	DESCRIPTION	COLOR	PKG.	UNIT
4WLS942-24-52	24"	2-SHELF SET	WOOD	1	SET
4WLS942-28-52	28"	2-SHELF SET	WOOD	1	SET



HALF MOON PIVOT AND SLIDE 2-SHELF SET - POLYMER TRAY

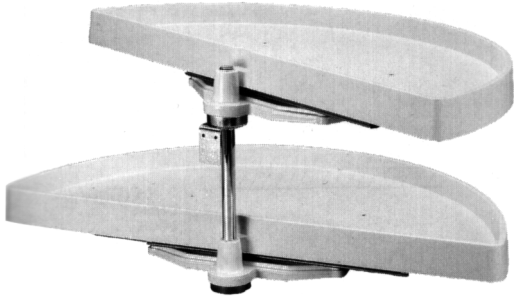

Minimum Inside Cabinet Depth

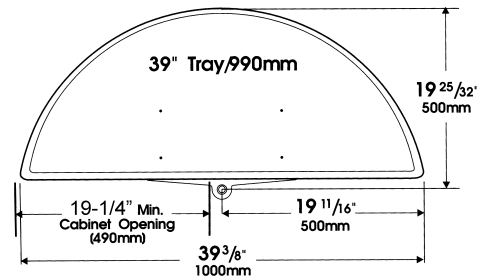
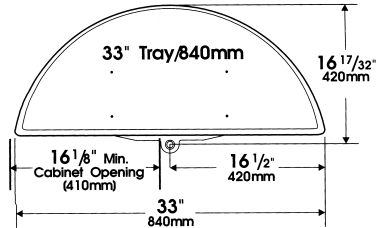
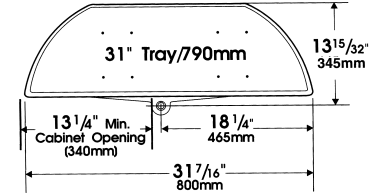
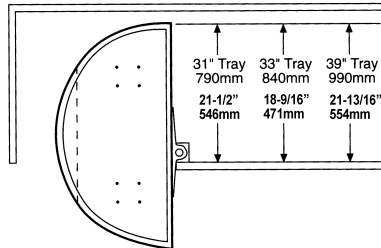

* Note: Minimum opening shown is for face frame cabinets.

- Standard bracket for face frame cabinet.
- Euro bracket for frameless cabinets, utilizing 90° blind corner base hinges. Euro bracket realigns the pivot point of trays to allow them to clear the door which (in this application) ends up inside the normal cabinet opening.

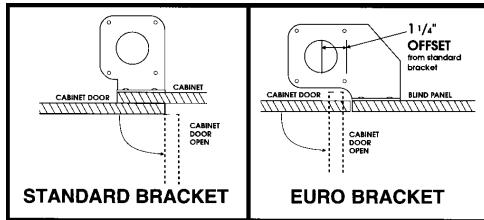

- **Contents:** Two shelf supports; two positioner bases; one bracket (6882-68-2), 17" center shaft, also includes template and instructions & two pair of slides.
- Tray system is based on minimum cabinet opening for the tray to pivot and pull-out. Therefore, when installing our tray system in a frameless cabinet with 90° BCB hinges, you must add 1-1/4" to our minimum opening dimensions. This will then provide a net minimum opening which will take into consideration for opening obstructions such as the door or the hinges.

ORDER #	DESCRIPTION	MIN. OPENING	COLOR	PKG.	UNIT
6882-31-11-570	2 SHELF SET	13-1/4"	WHITE	1	SET
6882-31-15-570	2 SHELF SET	13-1/4"	ALMOND	1	SET
6882-33-11-570	2 SHELF SET	16-1/8"	WHITE	1	SET
6882-33-15-570	2 SHELF SET	16-1/8"	ALMOND	1	SET
6882-39-11-570	2 SHELF SET	19-1/4"	WHITE	1	SET
6882-39-15-570	2 SHELF SET	19-1/4"	ALMOND	1	SET

HALF MOON PIVOT AND SLIDE 2-SHELF SET - WOOD TRAY



- 1" inside tray height; 1-5/8" outside rim height.

DIMENSIONS

- 4WLS882-32: Min. Opening 12"
- 4WLS882-35: Min. Opening 15"
- 4WLS882-38: Min. Opening 18"

INDIVIDUAL SETS

- **Set Contains:** 2 shelf supports, 2 positioner bases, 1 standard bracket, 1 Euro bracket, 17" shaft assy, 2 pair of slides, template & instructions.



ORDER #	SIZE	DESCRIPTION	COLOR	PKG.	UNIT
4WLS882-32-57	32"W	2-SHELF SET	WOOD	1	SET
4WLS882-35-57	35"W	2-SHELF SET	WOOD	1	SET
4WLS882-38-57	38"W	2-SHELF SET	WOOD	1	SET

WIRE HALF MOON GLIDE OUT

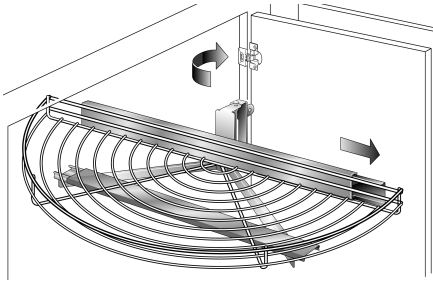

- Slide mounted shelf pivots out of blind corner cabinets & extends 13" on quiet, ball-bearing slides.
- Wire shelf includes 1-1/2" fence to hold tall items upright.
- Reversible design for either right or left hand cabinets.
- Includes a stop which may be field installed to prevent unit from hitting back of cabinet.

ORDER #	HEIGHT	MIN. OPEN.	COLOR	PKG.	UNIT
HM28G-W	1-1/2"	14-1/2"	WHITE	1	SET

BLIND CORNER KIT - PREMIERE CHROME



FEATURES

- Now with soft-close!
- Universal mounting hardware may be door mounted & used for left or right-hand applications.

SPECIFICATIONS

- **Min. Inside Width:** 34".
- **Min. Inside Depth:** 20-1/2".
- **Min. Door Opening (width):** 16-1/4"W
- **Min./Max. Opening Height:** 23-1/4" to 28".
- **Set Contents:** Soft-close Slide and pivot hardware and fasteners, 2 large chrome baskets, 2 small chrome baskets.

ORDER #	FINISH	PKG.	UNIT
5207-CR	CHROME	1	SET

KITCHENMATE CORNER PANTRY



- Prefinished and fully assembled unit pre-mounted to a plywood sled
- Simply insert into either 33" or 36" corner cabinet and attach 4 screws (supplied) through the base and into the cabinet deck.
- Heavy-duty, 200lb. full-extension slides make it ideal for pots, pans, appliances or bulk storage.
- Perfect for remodels; easily installed even with existing countertop intact
- 33"-high model allows installation of a top drawer

ORDER #	APPLICATION	SPECIES	PKG.	UNIT
P0615MNL1	36" CORNER CAB.	MAPLE	1	SET
P0610MNL1	32" CORNER CAB.	MAPLE	1	SET

KITCHENMATE BLIND CORNER CADDY



- Includes 2 shelf drawer kit with 100 lb full extension, ball bearing slides, premounted onto sled with vertical side panels (for the upper tray)
- Swing out, all solid wood storage bin
- Designed for everyday use and bulk storage
- Designed for 15" or larger openings
- Accessible from both sides

ORDER #	COLOR	PKG.	UNIT
P0650MNL1	MAPLE	1	KIT